

TYPICAL SECTIONAL ELEVATION

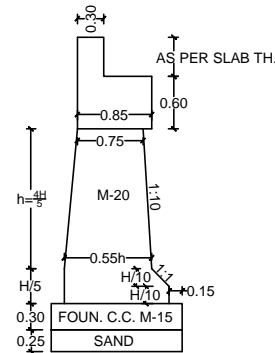

TYPICAL SECTION OF ABUTMENT

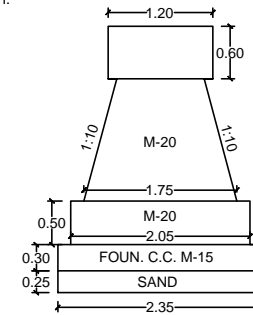

TYPICAL SECTION OF PIER

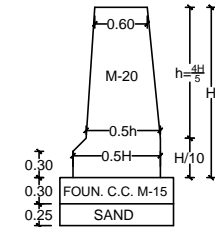

TYPICAL SECTION OF SQUARE RETURN

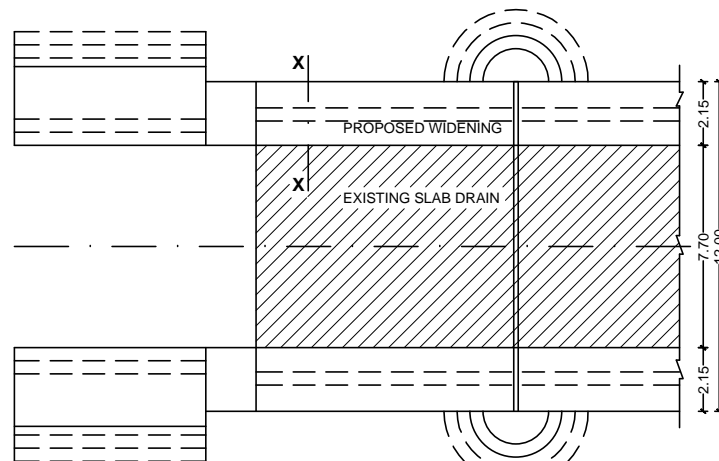

TYPICAL PLAN

REFERENCE :-

1. FOR REINFORCEMENT & OTHER DETAILS REFER STANDERD PLAN FOR HIGHWAY BRIDGES WITH R.C.C. SLAB TYPE SUPER STRUCTURE VOL. - II, ISSUED BY MINISTRY OF SURFACE TRANSPORT(ROAD WING) NEW DELHI.
2. FOR SECTION OF ABUTMENT & RETURN STANDARD SECTION AS PER S.V. NATU'S CIRCULAR (STATE SOR) SHALL FOLLOW.

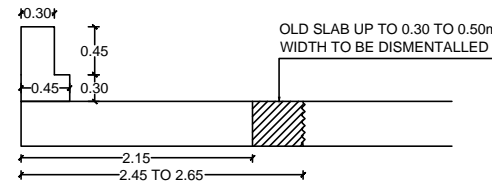

SECTION X-X

TYPICAL DRG. OF WIDENING OF SLAB CULVERTS (C/C SPAN 3.80mt & HEIGHT FROM G.L. UP TO 2.00mt)

DEPUTY EXECUTIVE ENGINEER
STATE ROAD PROJECT DIVISION
RAJKOT

EXECUTIVE ENGINEER
STATE ROAD PROJECT DIVISION
RAJKOT

SCALE :
NOT TO SCALE

STATE ROAD PROJECT DIVISION
RAJKOT

GOVERNMENT OF GUJARAT
ROADS AND BUILDINGS DEPARTMENT

SAVARKUNDLA – DHASA ROAD SH 021 & 236
ROAD MAINTENANCE PROGRAMME

DATE: PROJECT: DWG No: REV.